

D-19-2 (Data current as of 11/21/2022)G
BRENNAN FAMILY LIVING TRUST,
TC & DM BRENNAN TTEES
78 PUTNAM HILL ROAD
WILTON, NH 03086

D-19-5 (Data current as of 11/21/2022)G
TOWNSEND, PATRICIA A,
69 PUTNAM HILL ROAD
WILTON, NH 03086

D-20 (Data current as of 11/21/2022)
NIEHAUS, MATTHEW W & ADRIANE S,
203 WILSON ROAD
WILTON, NH 03086

D-40 (Data current as of 11/21/2022)G
GALLO, SANDRA S,
120 HOLT ROAD
PO BOX 119
WILTON, NH 03086

D-19-6
MITCHELL, JONATHAN & WILSON,
NANCY
77 PUTNAM HILL ROAD
WILTON, NH 03086

Abutters

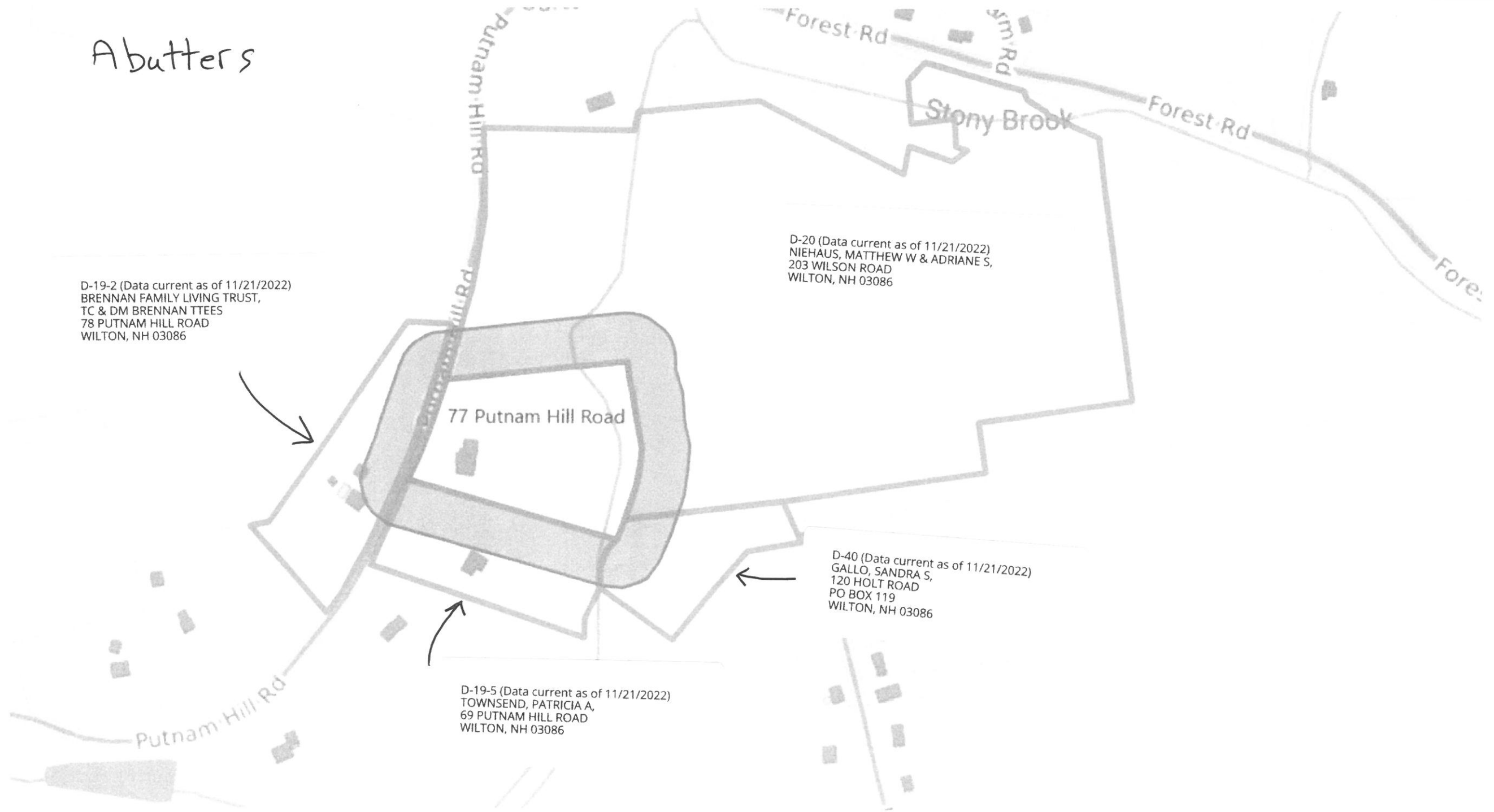

D-19-2 (Data current as of 11/21/2022)
BRENNAN FAMILY LIVING TRUST,
TC & DM BRENNAN TTEES
78 PUTNAM HILL ROAD
WILTON, NH 03086

D-20 (Data current as of 11/21/2022)
NIEHAUS, MATTHEW W & ADRIANE S,
203 WILSON ROAD
WILTON, NH 03086

D-40 (Data current as of 11/21/2022)
GALLO, SANDRA S,
120 HOLT ROAD
PO BOX 119
WILTON, NH 03086

D-19-5 (Data current as of 11/21/2022)
TOWNSEND, PATRICIA A,
69 PUTNAM HILL ROAD
WILTON, NH 03086