



REFERENCE PLAN:

"SUBDIVISION - PLAN OF LAND - CHARLES B. SULLIVAN - & - SAMUEL G. PROCTOR SR. - WILTON, NEW HAMPSHIRE" SCALE: 1"=50', DATED: FEBRUARY 15, 1984, PREPARED BY MONADNOCK SURVEY AND RECORDED AT H.C.R.D. AS PLAN #16556.

NOTES:

1. THE PURPOSE OF THIS PLAN IS TO DEPICT THE OBSERVABLE SITE CONDITIONS FOR OF LOT C-102.
2. THE CURRENT OWNER OF LOT C-102 IS NORTH FARM LLC, 395 ELM STREET, MILFORD, NH 03055.
3. LOT C-102 IS LOCATED IN THE COMMERCIAL DISTRICT. MINIMUM LOT REQUIREMENTS INCLUDE 200 FEET OF FRONTAGE, 35 FOOT FRONT BUILDING SETBACK, 25 FOOT SIDE BUILDING SETBACK, 20 FOOT REAR BUILDING SETBACK AND 50 FOOT SETBACK FROM WETLANDS.
4. OBSERVABLE PHYSICAL FEATURES AND TOPOGRAPHY ARE PER DIRECT FIELD LOCATIONS PERFORMED BY THIS OFFICE IN AUGUST, 2018. AERIAL IMAGES WERE UTILIZED TO SUPPLEMENT OFF SITE FEATURES SHOWN. NO UNDERGROUND UTILITY INVESTIGATION WAS PERFORMED AT THIS TIME.
5. VERTICAL DATUM IS NAVD 88 AND HORIZONTAL DATUM IS NEW HAMPSHIRE STATE PLANE.
6. BOUNDARY INFORMATION SHOWN IS ENTIRELY PER REFERENCE PLAN, THIS IS NOT TO BE CONSIDERED A BOUNDARY SURVEY.
7. FLOOD STUDY INFORMATION FOR LOT C-102 HAS BEEN DEPICTED AS A FEMA PRELIMINARY FLOODPLAIN.
8. WETLANDS SHOWN WERE DELINEATED BY THOMAS E. CARR OF THIS OFFICE DURING AUGUST, 2018 & VERIFIED BY JASON C. BOLDOC (CWS) OF THIS OFFICE IN JUNE 2023.

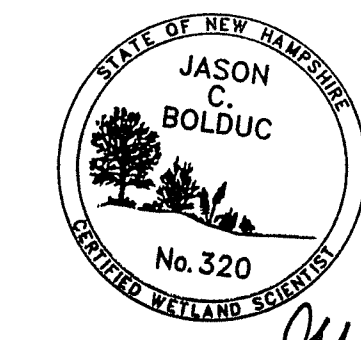

CERTIFICATION:

"I HEREBY CERTIFY THAT THE EXISTING OBSERVABLE IMPROVEMENTS SHOWN ARE THE RESULT OF A FIELD SURVEY PERFORMED BY THIS OFFICE IN AUGUST 2018."

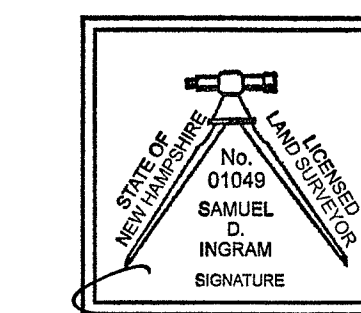

Signature of Jason C. Bolduc dated 1/19/2024.

EXISTING CONDITIONS PLAN
PREPARED FOR:

NORTHERN LIGHTS LANDSCAPE CONTRACTOR, LLC

LAND OF:
NORTH FARM LLC
TAX MAP C LOT 102
WILTON, NEW HAMPSHIRE

SCALE: 1" = 50'

JUNE 21, 2023

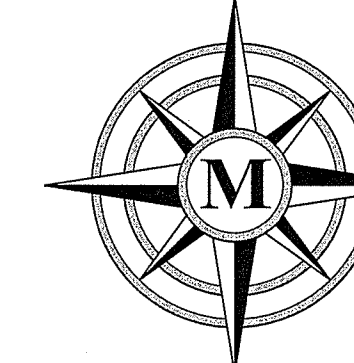

MERIDIAN

LAND SERVICES, INC.
ENGINEERING | SURVEYING | PERMITTING
SOIL & WETLAND MAPPING | SEPTIC DESIGN
31 OLD NASHUA ROAD, AMHERST, NH 03031 TEL. 603-673-1441
MERIDIANLANDSERVICES.COM FAX 603-673-1584

- LEGEND:
- RIGHT-OF-WAY SIDELINE
 - PROPERTY LINE
 - EDGE OF PAVEMENT
 - EDGE OF WETLANDS
 - EDGE OF WATER
 - 10' CONTOUR INTERVAL
 - 2' CONTOUR INTERVAL
 - C-102 EXISTING TAX MAP AND LOT #

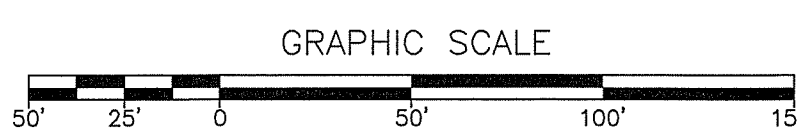

REV.	DATE	DESCRIPTION	C/O	DR	CK
D	--	--	--	--	--
C	8/18/23	AOT INITIAL SUBMITAL	--	MJR	SDI
B	8/16/23	PB COMMENTS	--	MJR	SDI
A	7/12/23	NRPC COMMENTS	--	MJR	SDI

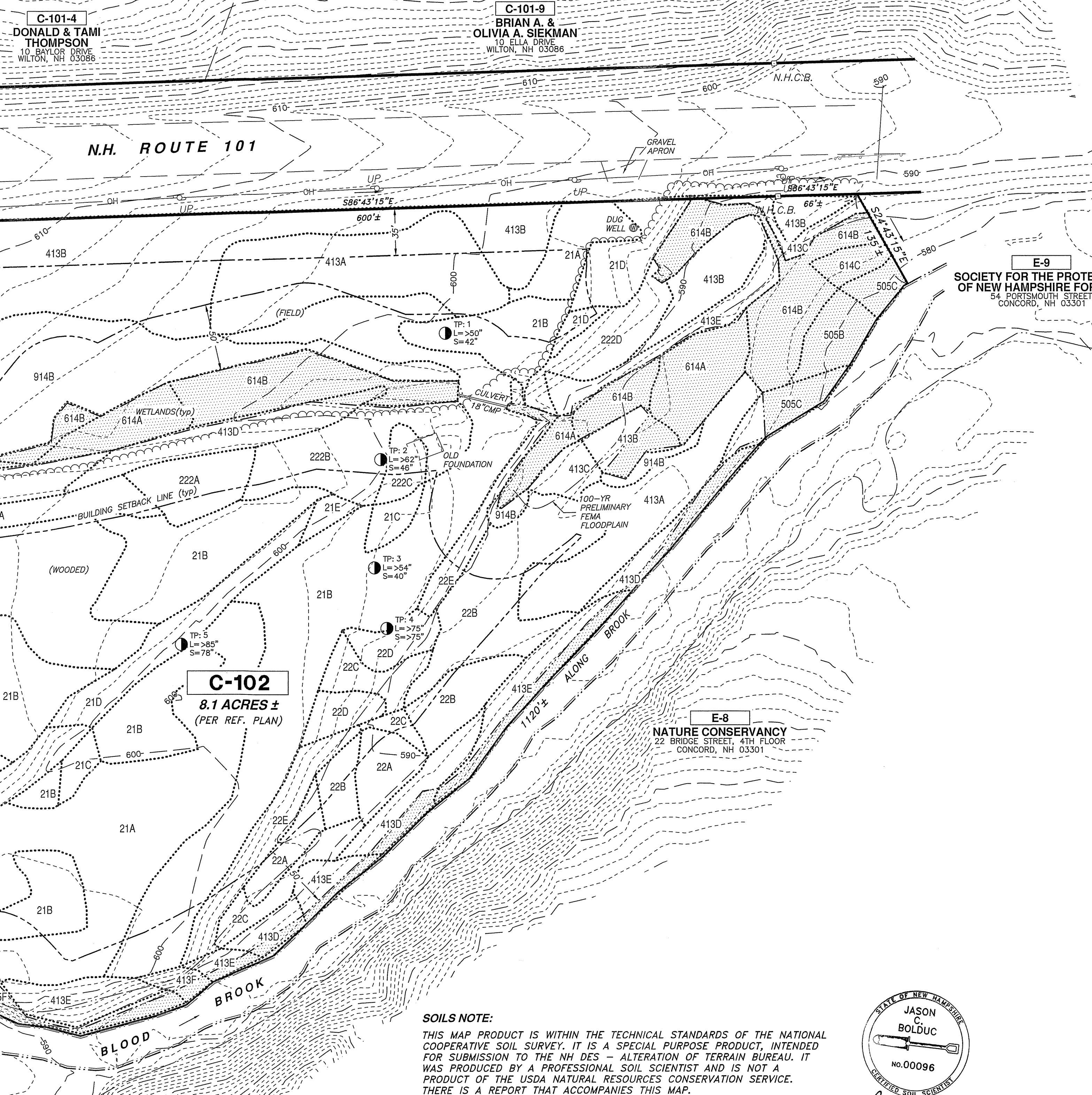

SOILS NOTE:

THIS MAP PRODUCT IS WITHIN THE TECHNICAL STANDARDS OF THE NATIONAL COOPERATIVE SOIL SURVEY. IT IS A SPECIAL PURPOSE PRODUCT, INTENDED FOR SUBMISSION TO THE NH DES - ALTERATION OF TERRAIN BUREAU. IT WAS PRODUCED BY A PROFESSIONAL SOIL SCIENTIST AND IS NOT A PRODUCT OF THE USDA NATURAL RESOURCES CONSERVATION SERVICE. THERE IS A REPORT THAT ACCOMPANIES THIS MAP.

SOILS LEGEND:

THE FOLLOWING ARE THE EXISTING SITE SPECIFIC SOILS MAPPED IN ACCORDANCE WITH SITE SPECIFIC SOIL MAPPING STANDARDS FOR NEW HAMPSHIRE AND VERMONT, SPECIAL PUBLICATION NO. 3-VERSION 7.0:

- | | | |
|-----|----------------------------|-------|
| 21 | COLTON GRAVELLY LOAMY SAND | HSG A |
| 22 | COLTON LOAMY SAND | HSG A |
| 222 | COLTON VERY STONY | HSG A |
| 413 | DUANE VERY GRAVELLY | HSG B |
| 505 | COHAS LOAM | HSG C |
| 614 | KINSMAN SAND | HSG C |
| 914 | DUANE VARIANT | HSG C |

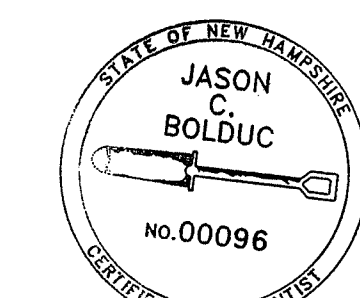

Signature of Jason C. Bolduc.

Plotfile: 1/15/2024 9:42 AM By: MJR
H:\MS\10738\10738.dwg