

RETAINING WALL SECTION
ELEVATION VIEW WALL - LOWER TIER
FACING FRONT OF WALL

SCALE - 1' = 10'

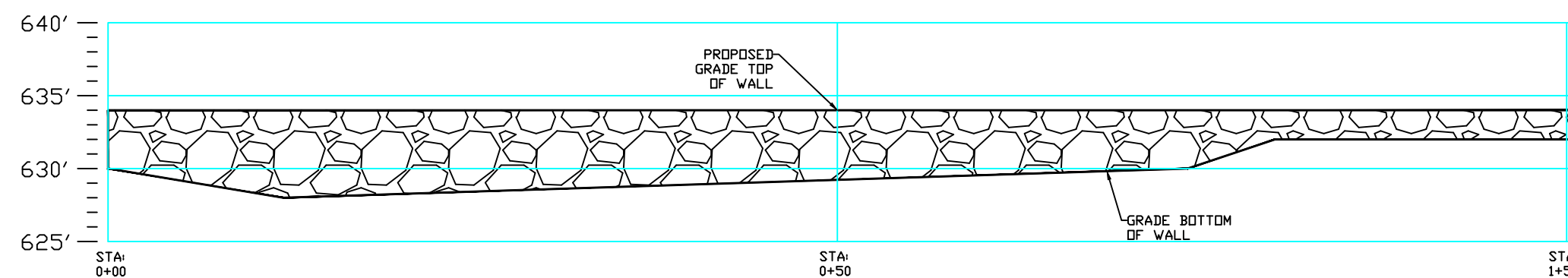

RETAINING WALL SECTION
ELEVATION VIEW WALL - MIDDLE TIER
FACING FRONT OF WALL

SCALE - 1' = 10'

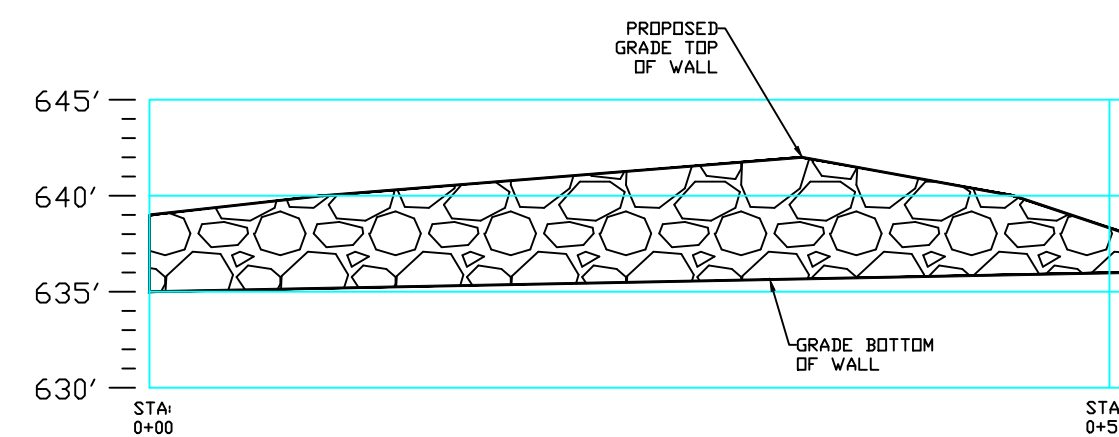

RETAINING WALL SECTION
ELEVATION VIEW WALL - UPPER TIER
FACING FRONT OF WALL

SCALE - 1' = 10'

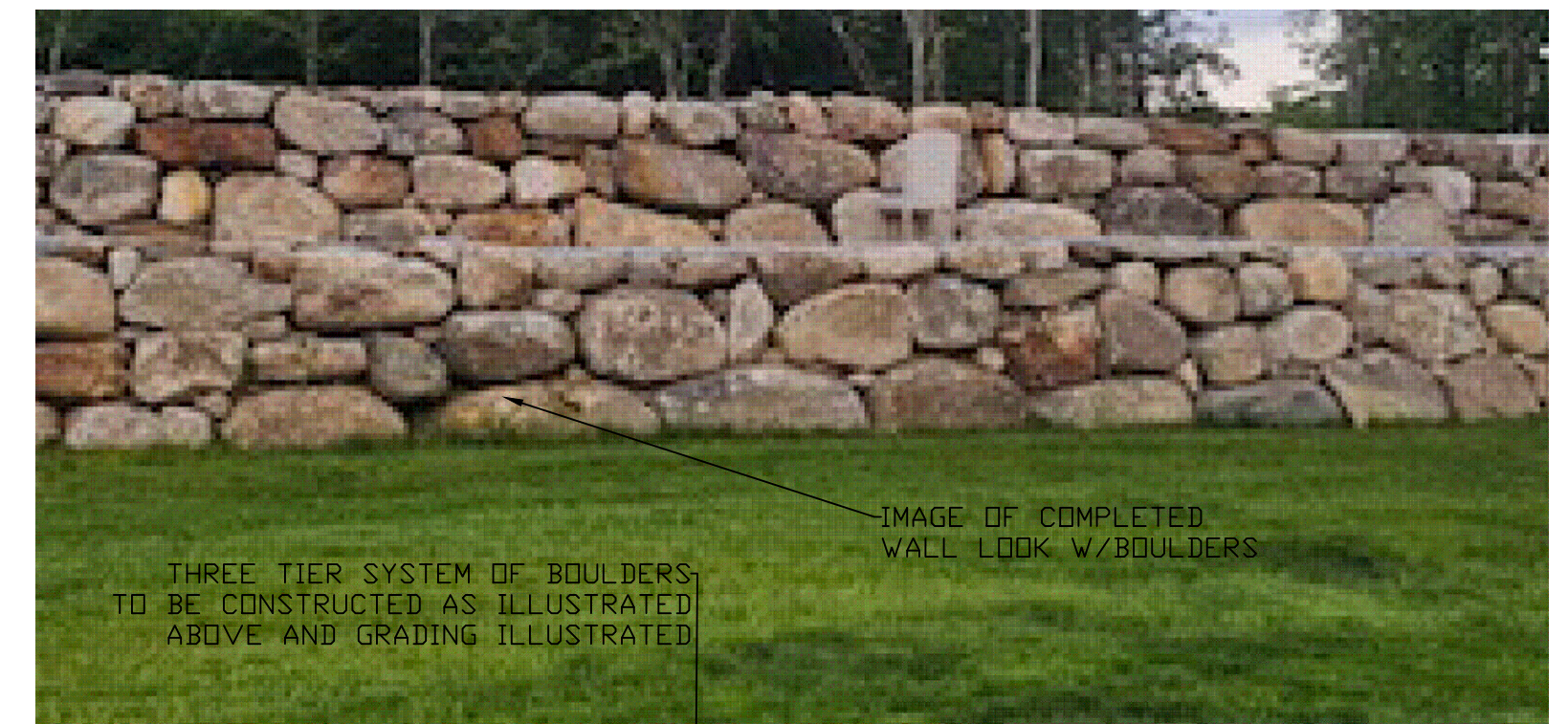

THREE TIER SYSTEM OF BOULDERS TO BE CONSTRUCTED AS ILLUSTRATED ABOVE AND GRADING ILLUSTRATED

IMAGE OF COMPLETED WALL LOOK W/BOULDERS

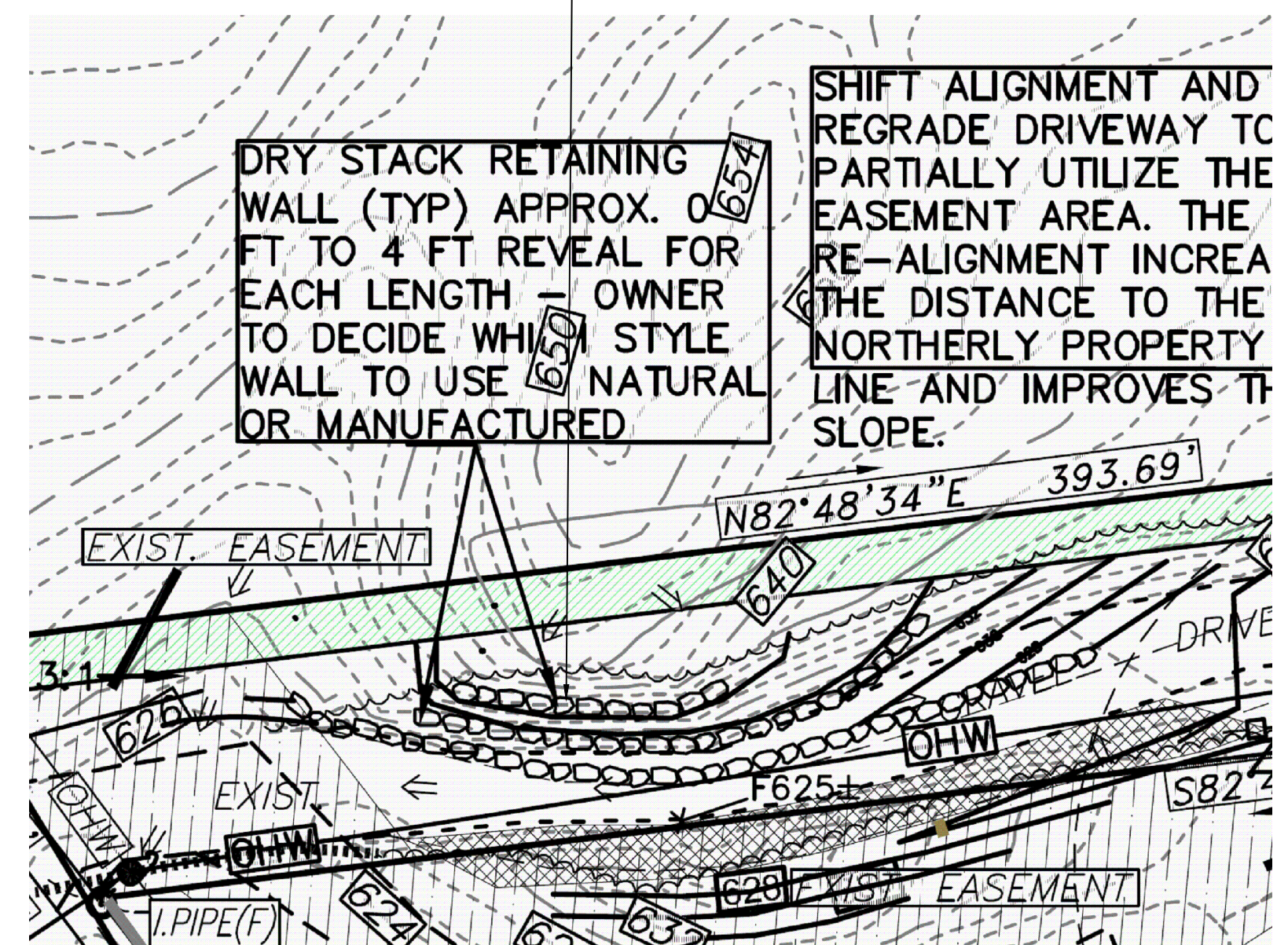

2' WIDE CHIMNEY OF FREE-DRAINING FILL
100% PASSING 2", 40-85% PASSING #4, 0-10% PASSING #200
COMPACT TO 95% OF STANDARD PROCTOR ASTM D698

GEOTEXTILE FABRIC - MIRAFI 140N
OR EQUAL - TOTAL HEIGHT BACK OF WALL

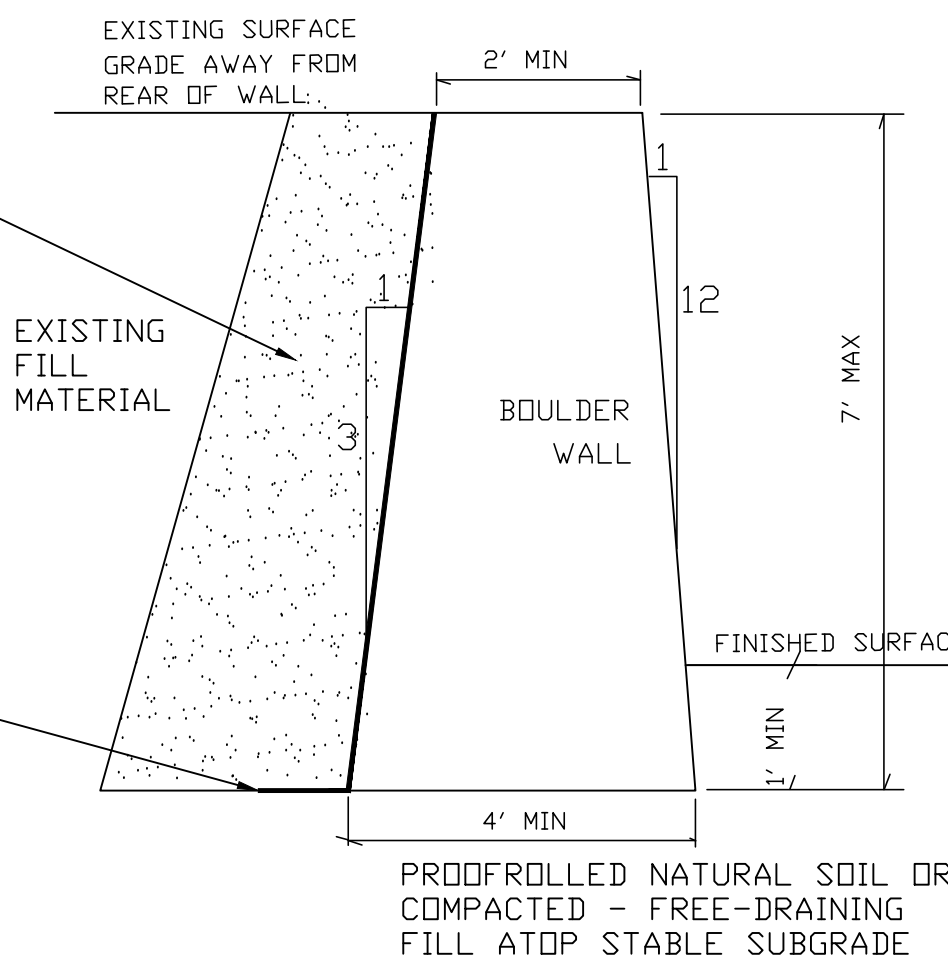

STONE RETAINING WALL DETAIL

NOT TO SCALE

NOTES:

1. WALL TO BE CONSTRUCTED TO LINE AND GRADE SHOWN ON PLANS. WALLS TO BE MINIMUM 12' APART FACE OF WALL TO FACE OF WALL (PLAN CURRENTLY SCALES AT 16' +/- SEPARATION).
2. WALL TO CONSIST OF ANGULAR TO SUB-ANGULAR BOULDERS AND RANGE FROM 4 TO 5 FEET IN LARGEST DIMENSION. BOULDER ORIENTATION AND PLACEMENT SHOULD BE SUCH THAT THEY TIP BACK TOWARDS THE REAR OF THE WALL. THREE POINTS OF CONTACT IS MINIMUM RECOMMENDED AND ROCKING STONES SHALL NOT BE PERMITTED.
3. LOWER COURSE TO BE EMBEDDED MINIMUM 1 FOOT BELOW GRADE.
4. MIRAFI 140N TO BE PLACED BEHIND WALL TO PROVIDE SEPARATION BETWEEN BACKFILL SOIL AND EXISTING SOIL.
5. FREE-DRAINING FILL TO CONSIST OF THE FOLLOWING 100% PASSING 2" SIEVE, 40-85% PASSING #4 SIEVE, 0-10% PASSING #200 SIEVE. MATERIAL TO BE PLACED IN MAXIMUM 12-INCH LIFTS AND COMPACTED TO MINIMUM 95% OF THE MAXIMUM DRY DENSITY DETERMINED IN ACCORDANCE WITH ASTM D698.
6. IF CONDITIONS ARE DIFFERENT THAN ASSUMED FOR DESIGN - CONTACT CIVIL CONNECTION, LLC.
7. WEEP HOLES TO CONSIST OF NATURAL WEEP HOLES LEFT BETWEEN ADJACENT STONES - IF NECESSARY 2" PVC PIPE MAY BE SET IN THE WALL TO EXTEND FROM THE REAR DRAINAGE AND OUT THE FACE OF THE WALL.

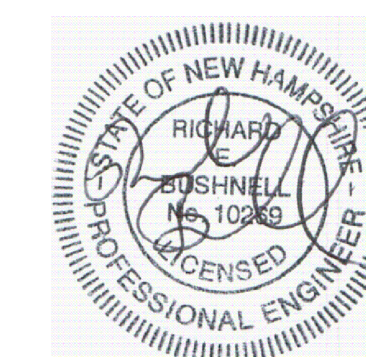

BOULDER WALL CONSTRUCTION PLAN
TAX LOT F-3-2
ISAAC FRYE HIGHWAY
WILTON, NEW HAMPSHIRE

DATE: 1/8/24	REVISIONS PER REVIEW	DATE: 9/9/23	DRAWN BY R. BUSHNELL, P.E.
		PROJ. NUMBER 23-423	CHECKED BY R. BUSHNELL, P.E.

SHEET
1 OF 1

PREPARED FOR:
SAN KEN HOLMES
NEW IPSWICH, NH

PREPARED BY:
CIVIL CONNECTION, LLC.
38 EDWARDS DRIVE, GILMANTON NH, NH 03837
TEL: (603) 393-9842