

ABUTTERS LIST

- | | | | |
|------------|--|------------|---|
| A-21, A-30 | JENNY D. McCALLION
480 19 TH STREET NW
NAPLES, FLA 33940 | A-81, A-84 | DON R. TAYLOR
DOROTHY B. TAYLOR
136 DUGGIN ROAD
WILTON, NH 03086 |
| A-22 | THE BLAGBROUGH FAMILY REALTY
TRUST
CORINNE F. BLAGBROUGH, TRUSTEE
293 BURTON HIGHWAY
PO BOX 870
WILTON, NH 03086-0870 | A-82 | HARLAND H. SAVAGE, SR
19 FRYE MILL ROAD
WILTON, NH 03086 |
| A-17 | MICHAEL J. PASQUARELLA
109 STILES FARM ROAD
WILTON, NH 03086 | A-83 | E. B. FRYE & SON, INC.
12 FRYE MILL ROAD
WILTON, NH 03086 |
| A-20 | REBEKAH KAYMAN
371 BURTON HIGHWAY
WILTON, NH 03086 | A-85-1 | DOUGLAS P. BRATTEN
TOSHIE S. BRATTEN
374 BURTON HIGHWAY
WILTON, NH 03086 |

REFERENCE PLAN:

"SUBDIVISION PLAN OF LAND, ROYDEN SANDERS, JR., WILTON, N. H."
SCALE: 1" = 100' DATED JUNE 17, 1976 PREPARED BY THOMAS F. MORAN,
INC. (HCRD PLAN NO. 9478).

NOTES:

- OWNER OF RECORD IS JENNY D. CLARY McCALLION, 480 19TH STREET NW, NAPLES, FLA 33940.
- TITLE REFERENCE TO THE PARCEL IS HC RD PROBATE DOCKET NO. 110780. THE PARCEL IS SUBJECT TO WATER, PIPELINE, CANAL AND FLOWAGE RIGHTS. FOR DESCRIPTION SEE HC RD BOOK 1367 PAGE 348 DATED JULY 29, 1944.
- TOTAL AREA OF THE PARCEL IS 28.4 ACRES PER TOWN OF WILTON ASSESSORS RECORDS.
- ZONING DISTRICT IS GENERAL RESIDENCE AND AGRICULTURAL. THE PARCEL IS IN THE WATERSHED OVERLAY DISTRICT.
- THE INTENT OF THIS PLAN IS TO PROVIDE FOR A LOT LINE ADJUSTMENT TO ALLOW FOR FUTURE ROADWAY REALIGNMENT AND BRIDGE RELOCATION.
- PARCEL 'A' IS NOT TO BE CONSIDERED A SEPARATE BUILDING LOT, BUT WILL BE CONVEYED TO THE TOWN OF WILTON AND BECOME A PART OF THE BURTON HIGHWAY.
- THE AREA OF LOT A-21 AFTER THE LOT LINE ADJUSTMENT IS 28.4 ACRES.
- THE PARCEL IS PARTIALLY WITHIN THE 100 YEAR FLOOD PLAN CONSERVATION DISTRICT. THE FLOOD LIMITS ARE TO BE DETERMINED PRIOR TO THE DESIGN OF THE RECONSTRUCTION PROJECT.

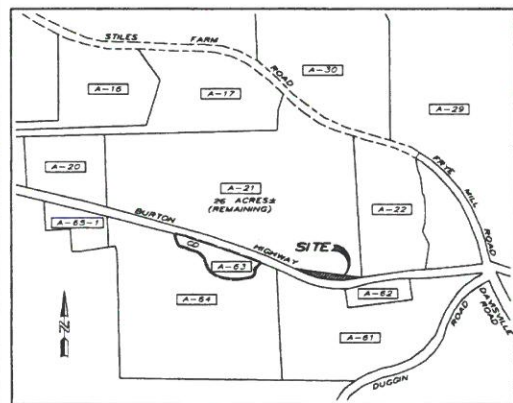

LOCATION PLAN
SCALE: 1" = 400'

OWNER'S SIGNATURE

Jenny D. Clary McCallion 8-25-98
DATE
JENNY D. CLARY McCALLION
TOWN OF WILTON
Stuart S. Draper 8-24-98
DATE
STUART S. DRAPER, SELECTMAN
Jerry W. Greene 8-24-98
DATE
JERRY W. GREENE, SELECTMAN
David W. Glines 8-24-98
DATE
DAVID W. GLINES, SELECTMAN

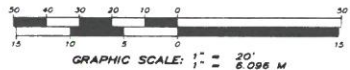

I HEREBY CERTIFY THAT THIS PLAN IS THE RESULT OF AN ACTUAL SURVEY MADE ON THE GROUND AND HAS A MINIMUM RELATIVE ERROR OF CLOSURE OF ONE PART IN TEN THOUSAND ON ALL PROPERTY LINES. ALL MONUMENTS WERE FOUND OR SET AS SHOWN.

8/20/98
DATE

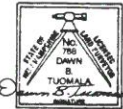

REV.	DATE	DESCRIPTION	DR	CHK
1	8/16/98	ADD ADJUDICATORY AND REVISE NOTES	GR	DMT
2	8/16/98	REVISE NOTES	GR	DMT

29508

dw 134